

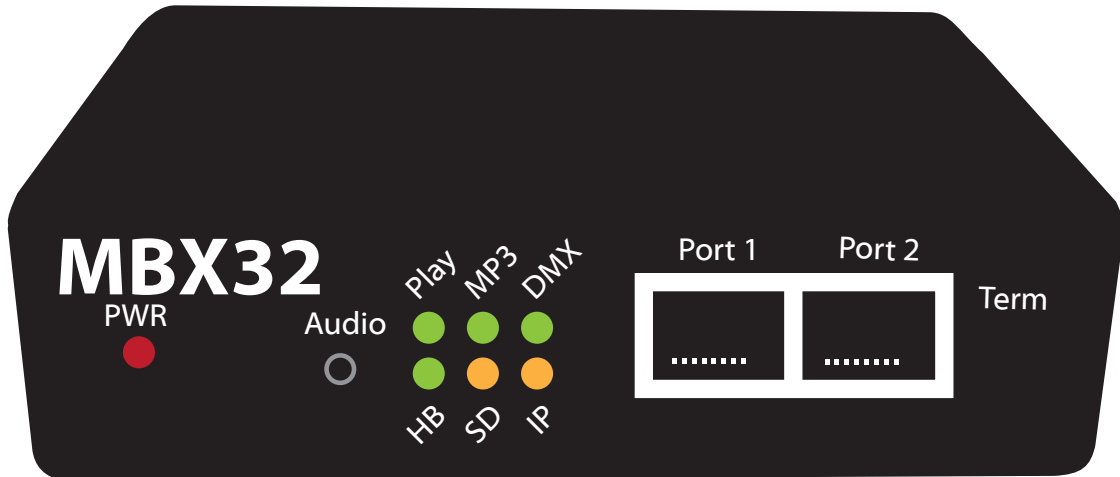

MBx32

Light Show
Computer



Updated: Feb 8, 2014

A User's Manual

SUMMARY

Animated Lighting's MBx32 is a powerful light show computer. It is the newest version of and the predecessor to our MonsterBrain product. The MBx32 stores and plays Animated Lighting's light shows consisting of lights and audio fully synchronized and preprogrammed for a truly impressive plug and play show right out of the package.

The **MBx32** paired with our light controllers (**LC-16** or **LD-16**) can control standard or LED Christmas light strings or other 110V AC products.

The **MBx32** paired with our **Pixel Driver** controls RGB pixel products (our Vivid RGB pixel product line such as the **Pixel360** or **Orb** products).

The **MBx32** paired with our DC controller (**DC-24**) can control low voltage "analog" LED products (our Vivid RGB Analog product line such as the **Analog Ribbon** and the **Analog Modules**).

For more information on this and more, contact our sales department at:

sales@animatedlighting.com

For support outside the scope of this manual, contact our support team at :

support@animatedlighting.com

GENERAL INFORMATION

Identify Peripherals

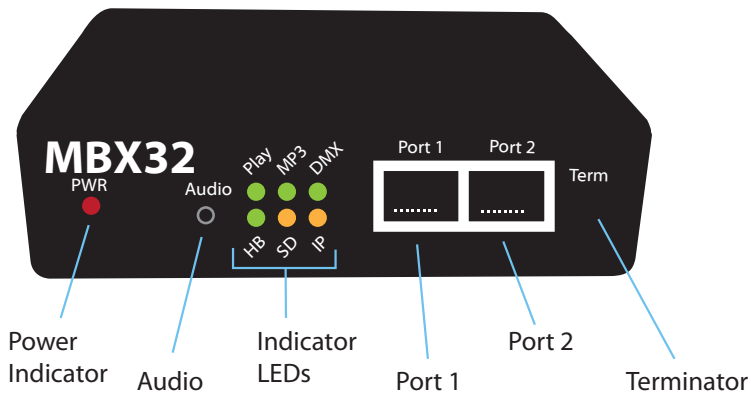

FRONT

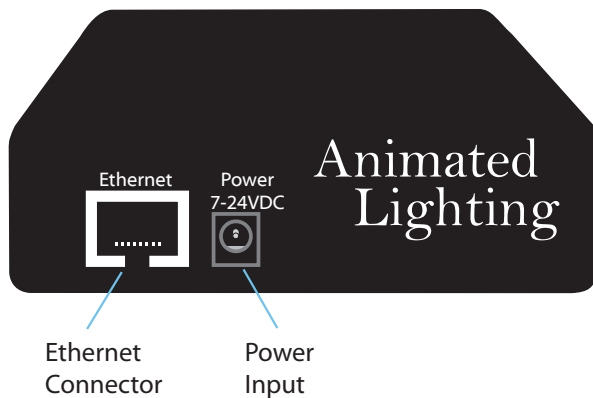

LEFT SIDE

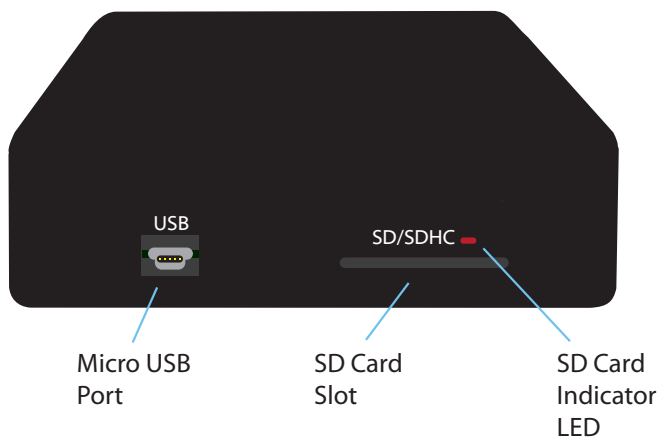

RIGHT SIDE

GENERAL INFORMATION

Peripheral Descriptions

A. **Power indicator** - A red indicator LED signifies that power is connected.

B. **Audio** - Connector is 3.5mm female phono jack. Sends a normal high-Z computer level audio signal, therefore it must be connected to a high-Z input device (ie stereo receiver, fm transmitter, certain high-Z inputs on a mixing board). The device cannot be directly connected to a power amplifier or other low-Z device.

C. **Indicator LEDs** (1 - 6) -

- Play - ON - Signifies a show is currently playing
- MP3 - ON - Signifies that an MP3 is currently playing
- DMX - ON - Signifies that a DMX file is currently playing
- HB - Slow flash (~1sec) - signifies "OK" working status of unit
- SD - OFF - Signifies "OK" SD card
- IP - Generally OFF - **Pulses the IP address digits at startup**

D. **Port 1** - This is commonly the ACL port. Connect your standard light controllers (LC-16) to this port.

E. **Port 2** - This is commonly the XDMX port. Connect your Pixel Driver to this port. Up to 2 pixel drivers can be connected.

F. **Terminator** - Place a jumper on these two pins if you experience "shaky" looking light shows or light shows that appear to flicker and strobe in a way that is unintended.

G. **Ethernet Connector** - Plug your MB into your internet router for a minimum of 3 hours to automatically update the time.

H. **Power Input** - Connects to the provided 7 to 24Vdc power adapter. **Connecting power to the MBx32 is the very last step in setting up your system.**

I. **Micro USB Connector** - **Reserved USB connectivity**

J. **SD Card Slot** - Insert show card here. Push card all the way into the slot until it "clicks" and remains flush with the enclosure.

K. **SD Card Indicator** - **What does this do?**

PORT 1

Typical Port 1 Configuration

For use with LC-16 Light Controllers

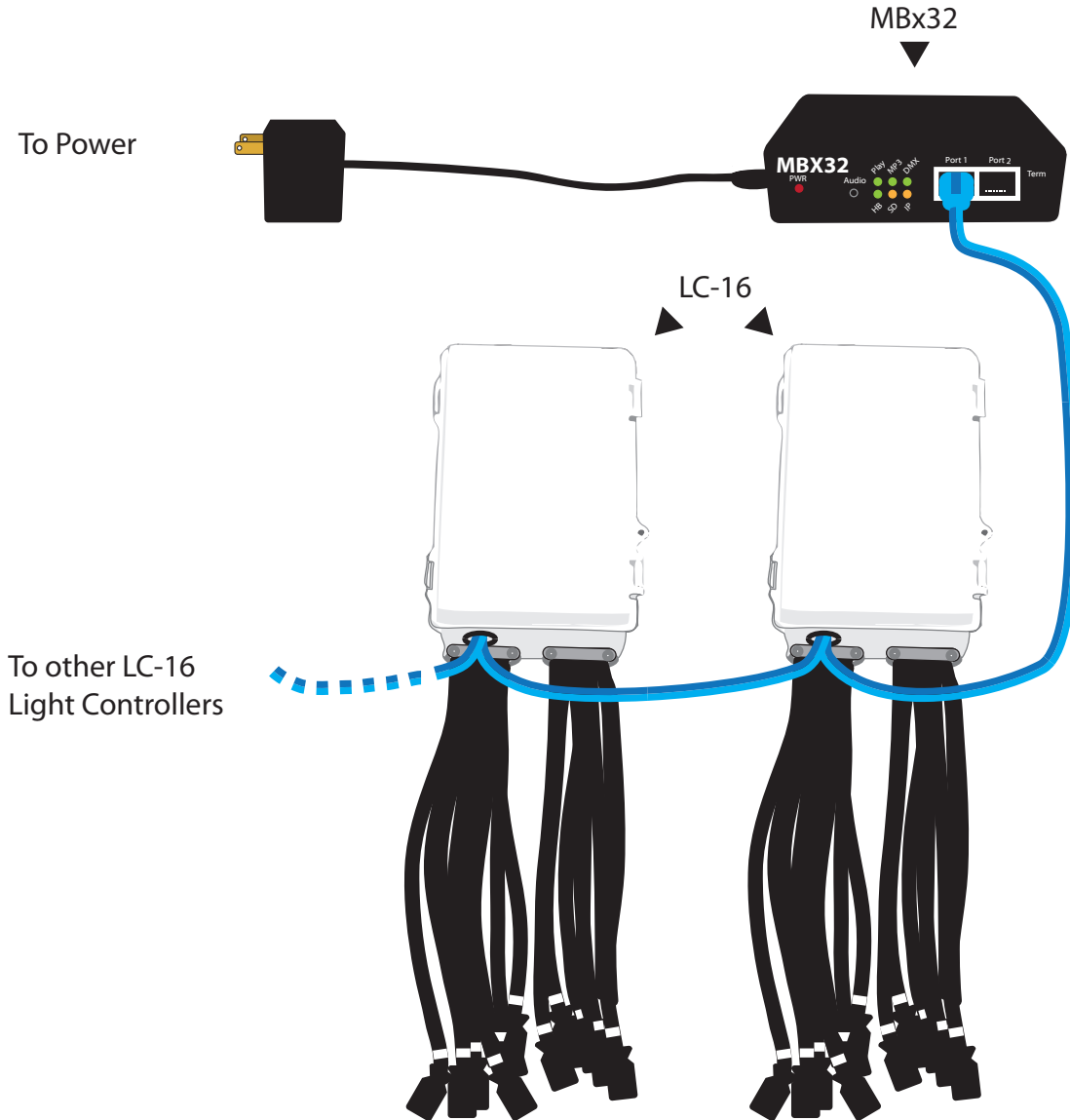

PORT 2

Typical Port 2 Configuration

For use with Pixel Driver RGB Controllers

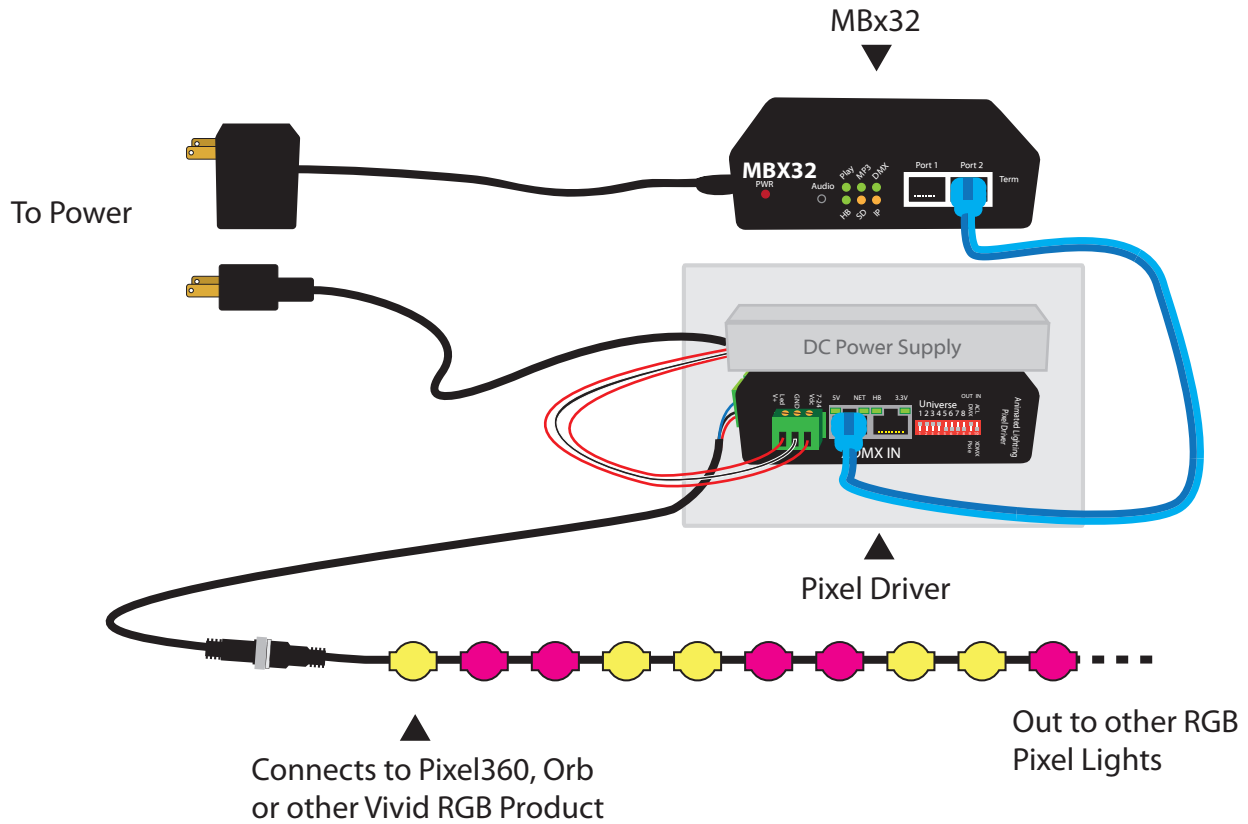

DUAL PORT

Both Ports can be used Simultaneously

Operate LC-16 Light Controllers and Pixel Drivers at the same time.

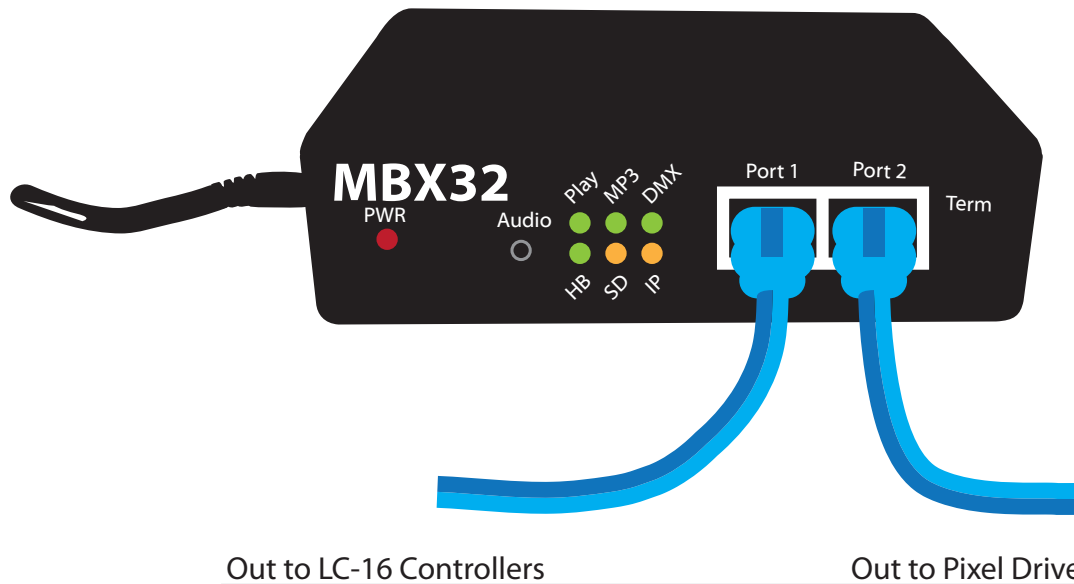

AUDIO

Connect Speakers or FM Transmitter

Using a 3.5mm male stereo phono jack



Note: Do not connect the MBx32 directly to a power amplifier or other low-Z input device.

TROUBLESHOOTING

MBx32 -

- No Power and No Indicator Lights - check to make sure that the DC Transformer is plugged into the MBx32 and that the DC Transformer is plugged into a power outlet. If plugged into a surge protector or power strip, make sure the strip is on.
- No Show is playing - Check to make sure that the HB indicator light on the MBx32 is blinking. If HB is not blinking, please contact Animated Lighting. Check to make sure that the PLAY indicator light is on. If it is on and you don't see a show, please troubleshoot your LC-16 controller on the following page. If don't see the PLAY indicator light on, then your SD is not currently playing a show. Your show may be a 'timed' show with scheduled start and stop times. If so, wait until the time of the show, then start the show again. If the PLAY light is off and you have not purchased a timed show, please contact Animated Lighting.
- All 6 indicator lights are flashing together steady - Eject then reinsert the SD card
- All 6 indicator lights are snaking around in a circle then lighting one single light - this is a show card error. Please contact Animated Lighting for a card replacement.
- Slow blinking HB light, all other indicators off - Check to make sure that the SD card isn't locked. Remove the card from the unit by pressing the card further into the slot. Once it clicks, the card will pop out. Remove the card from the slot and check the small slider switch on the side of the card. Confirm that it is in the "unlocked" position.
- No Audio - Make sure that your speakers are connected to the Audio jack on the front of the MBx32. Check to make sure that the MP3 indicator light on the unit is on. If the indicator is on and you do not have audio output, make sure that your speakers are turned on and that all cable connections have been made. If you do not see the MP3 indicator light on, then the SD card believes that no music should be playing at this time. If this is incorrect, please contact Animated Lighting for SD card update.

Power reset is required for all settings changes to take affect. To reset the power, remove the power cable, wait 2 seconds, then reinsert the power cable and allow the unit a few seconds to power up.